



Point ISO 1 Product Magnet Mount Installation Instructions

**Please refer to Point Quick Start Guide for
further instructions**

MONTAG 1 PRODUCT POINT INSTALL

J-BLOCK MOUNTING

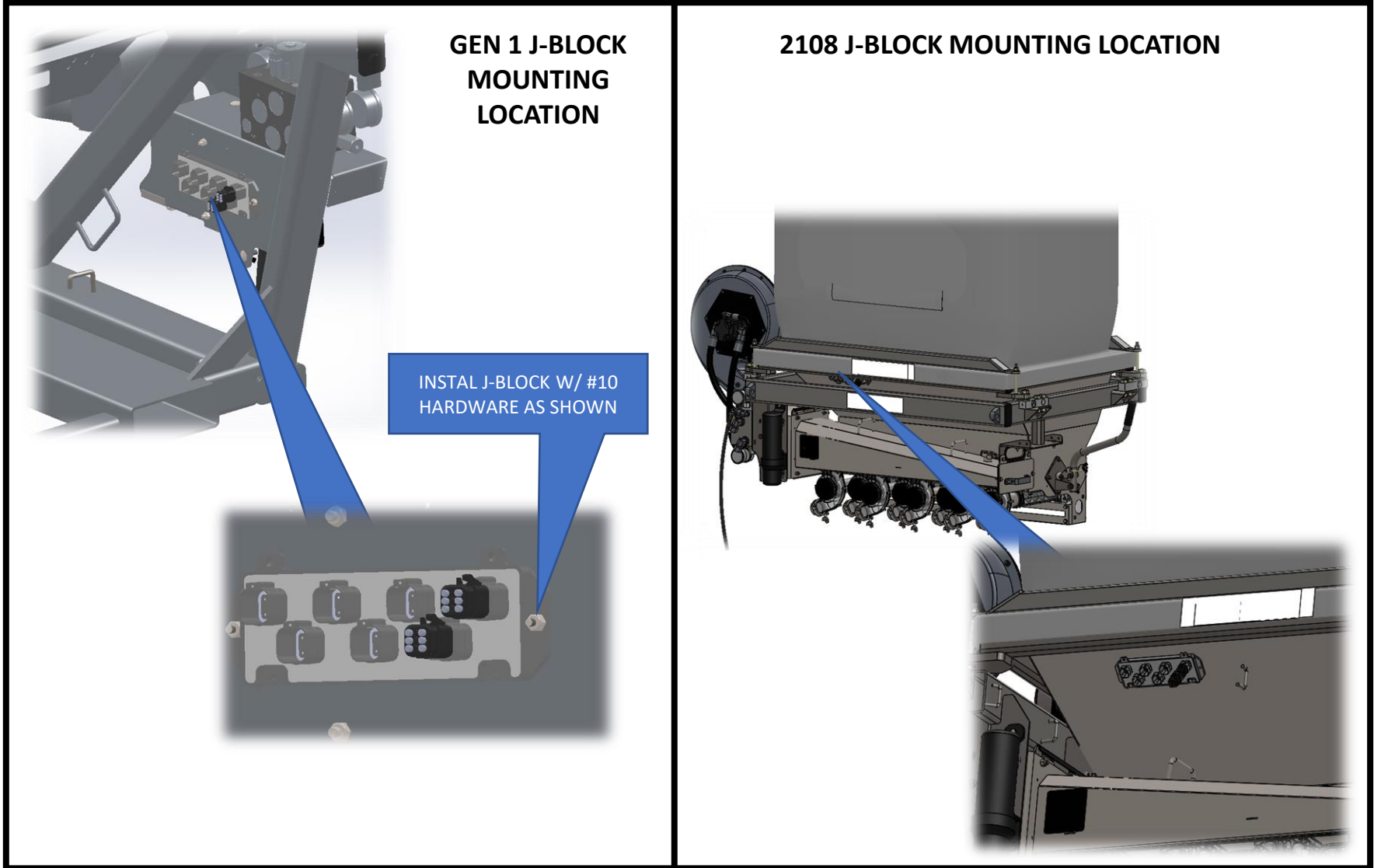



MONTAG 1 PRODUCT POINT INSTALL

GEN 1 LOAD CELL MOUNTING

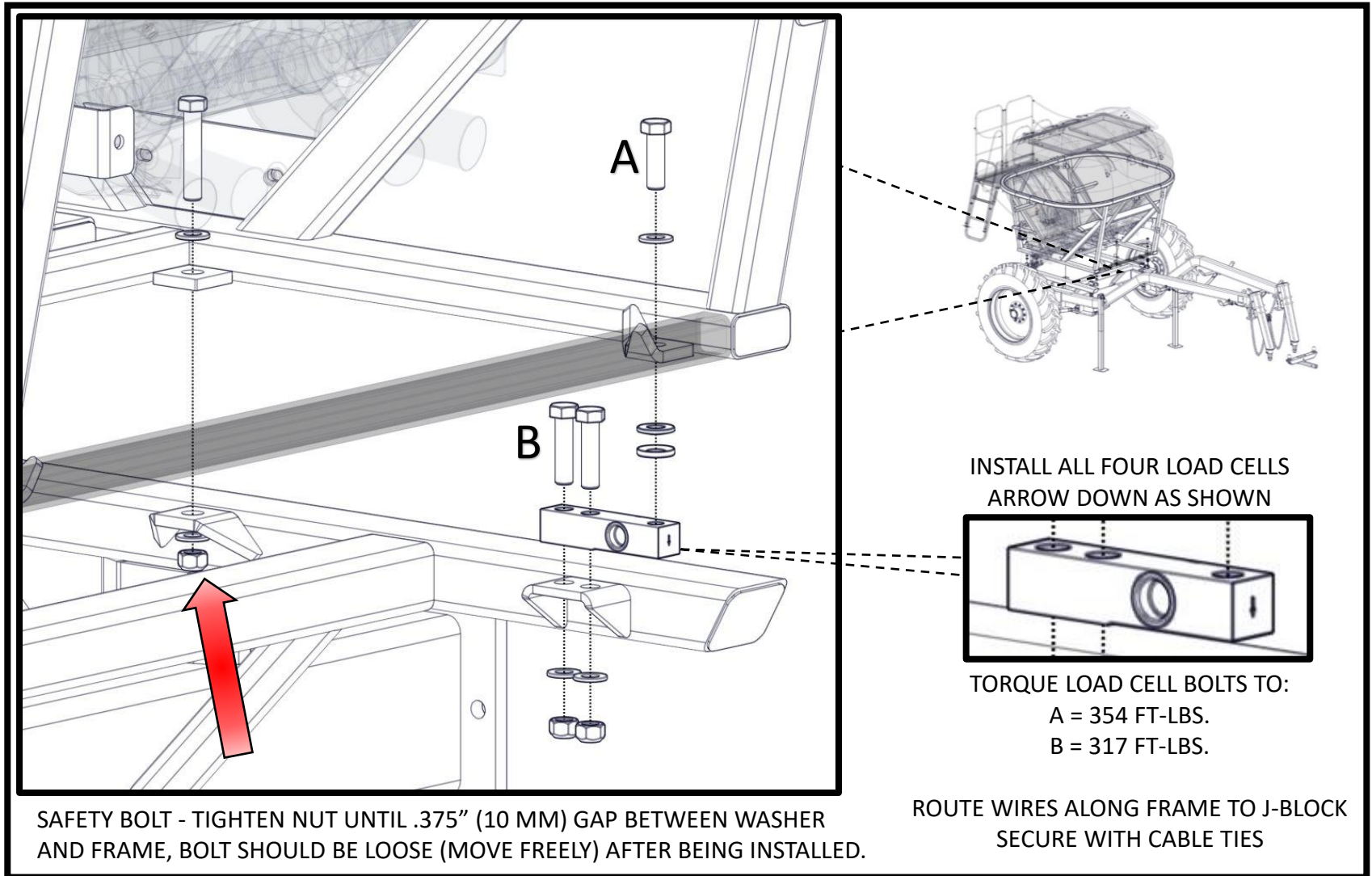

MONTAG 1 PRODUCT POINT INSTALL

GEN 1 POINT W/ BRACKET MOUNTING

IF YOUR KIT HAS THIS BRACKET FOLLOW THESE INSTRUCTIONS. IF NOT PROCEED TO PAGE 6.

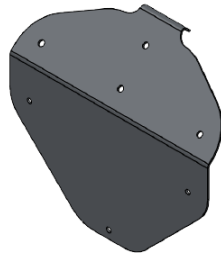

1. USE THE (3) COUNTERSUNK SCREWS AND (3) M5-0.8 LOCK NUTS TO MOUNT THE 3 MAGNETS TO THE PLATE AS SHOWN.

2. APPLY THE SUPPLIED THREAD LOCKER TO THE (3) BUTTON HEAD M5-0.8 SCREWS TO MOUNT THE POINT TO THE MOUNTING BRACKET.

****CAUTION: MAGNETS ARE VERY STRONG. CARE SHOULD BE TAKEN TO AVOID FINGERS BEING PINCHED BETWEEN MAGNETS AND STEEL. ZIP TIE ANY WIRES THAT MAY RUB EDGES OF OTHER PARTS. ****

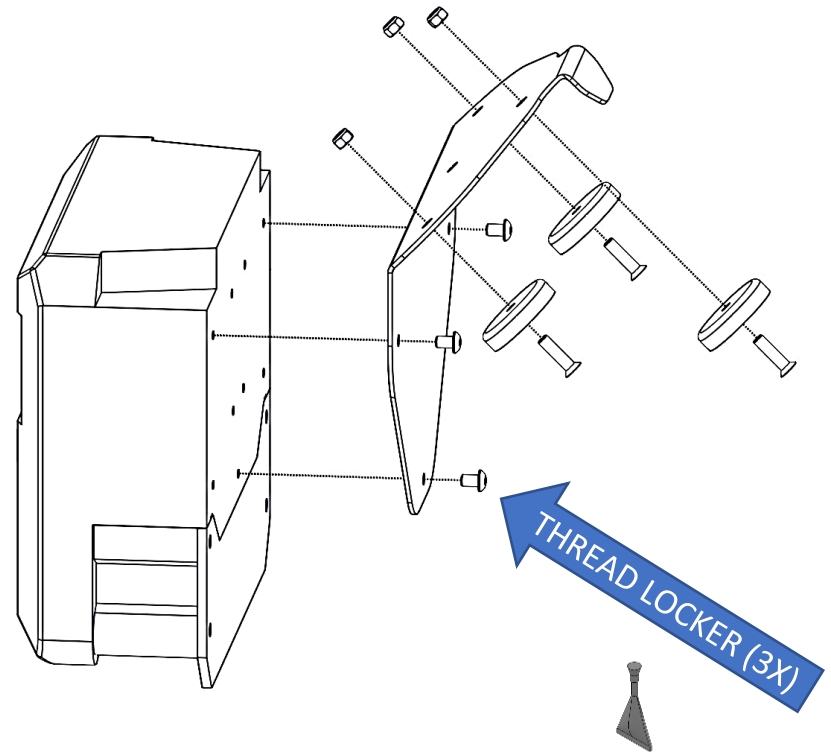



MONTAG 1 PRODUCT POINT INSTALL

GEN 1 POINT W/ BRACKET MOUNTING

MOUNT THE POINT BRACKET ASSEMBLY SECURELY TO LOWER SAG BAR AS SHOWN.

****CAUTION: MAGNETS ARE VERY STRONG. CARE SHOULD BE TAKEN TO AVOID FINGERS BEING PINCHED BETWEEN MAGNETS AND STEEL. ****

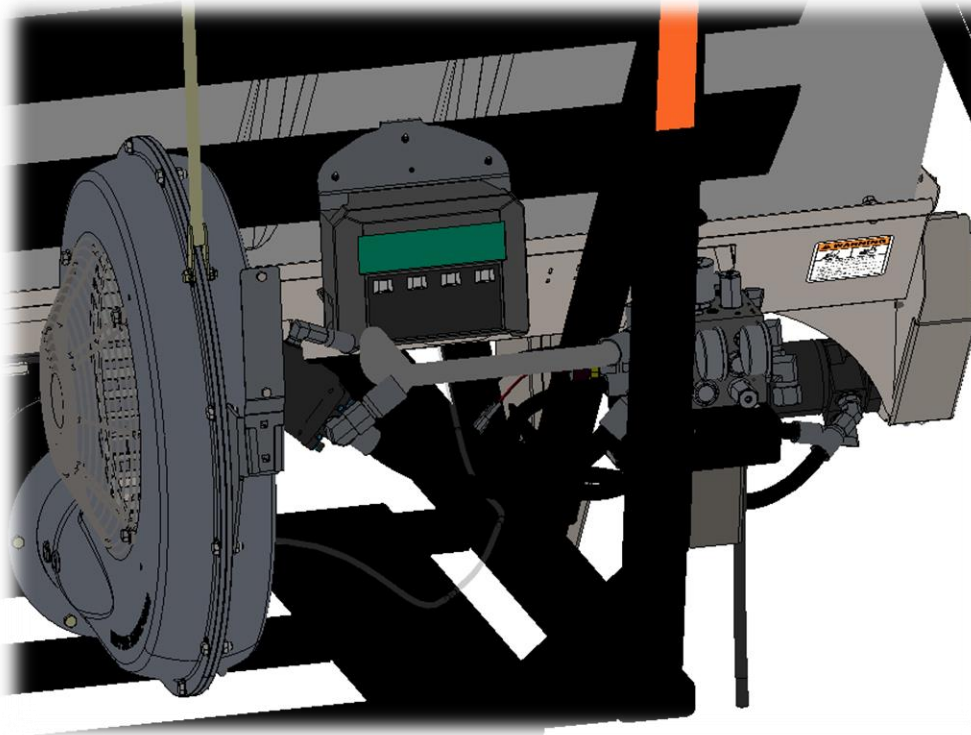

MONTAG 1 PRODUCT POINT INSTALL

OPTIONAL GEN 1 & 2108 POINT MOUNTING

IF YOUR KIT DOES **NOT** HAVE THIS BRACKET FOLLOW THESE INSTRUCTIONS.

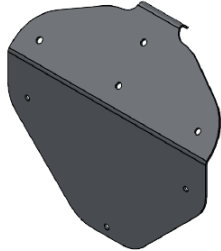

DETERMINE MOUNTING FOR SCALE LOCATION BASED ON USER PREFERENCE AND HARNESS LENGTH.

REMOVE SCREWS FROM UPPER “POINT” RAIL MOUNT AND USE 3 OF THEM TO INSTALL MAGNETS. ALL 3 MAGNETS SHOULD FULLY ENGAGE THE STEEL FRAME IT IS MOUNTED TO. (MAGNET LOCATIONS MAY VARY BASED ON WHERE YOU ARE PLACING IT ON THE UNIT)

****CAUTION: MAGNETS ARE VERY STRONG. CARE SHOULD BE TAKEN TO AVOID FINGERS BEING PINCHED BETWEEN MAGNETS AND STEEL.****

MONTAG 1 PRODUCT POINT INSTALL

POINT HARNESS CONNECTIONS



1. Connect 8 Pin connector to Point and the 6 Pin to the ISOBUS "SCALE/CAN" connector on rate controller harnessing. (example: MDRC connection shown below.)

2. Install 6 Pin load cell plug in Point port shown. Connect other 6 Pin end to J-block found on machine.

For JD rate controllers, the 407637/P000455 harness will plug into the 6 Pin ISO connector.

OR

MONTAG 1 PRODUCT POINT INSTALL

POINT HARNESS CONNECTIONS

**CONNECTING HARNESS
FROM J-BLOCK TO ISOBUS
CAN LINE WILL DAMAGE
POINT AND VOID WARRANTY**

**IMPORTANT: FOR
MDRC
CONTROLLERS DO
NOT CONNECT 6
PIN SCALE/CAN TO
J-BLOCK**

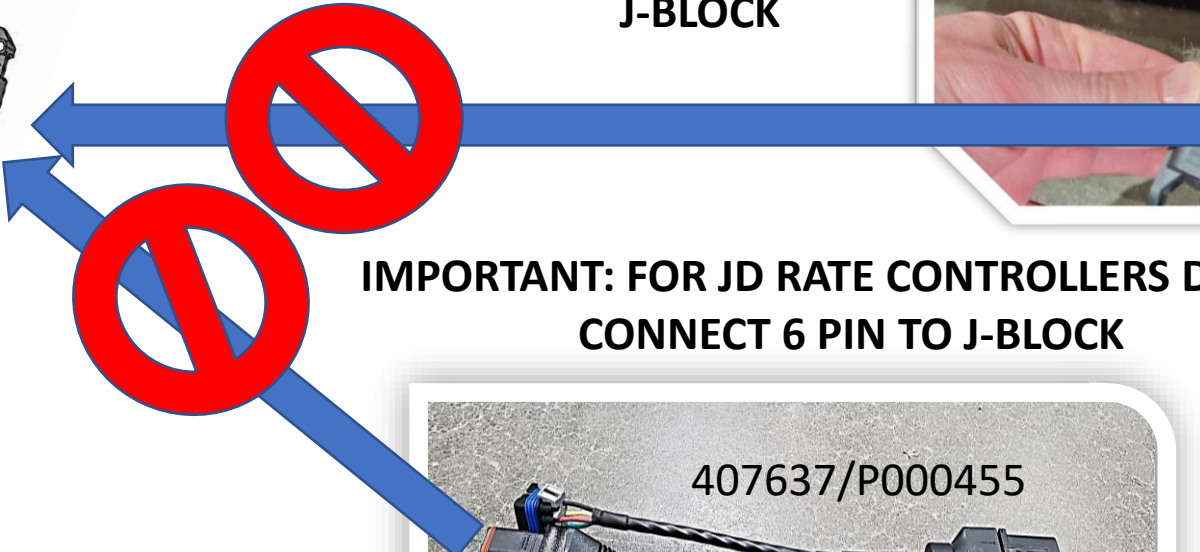
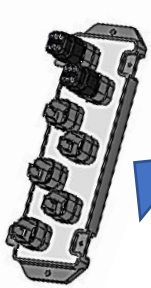

**IMPORTANT: FOR JD RATE CONTROLLERS DO NOT
CONNECT 6 PIN TO J-BLOCK**





MONTAG 1 PRODUCT POINT INSTALL

CREATE USER ACCOUNT AND UPDATE POINT TO LATEST VERSION

- 1) Download and open the Scale-Tec "Point" App on mobile device
- 2) Create Point account and log in
- 3) Power on Point Device
- 4) Follow the red arrows below:

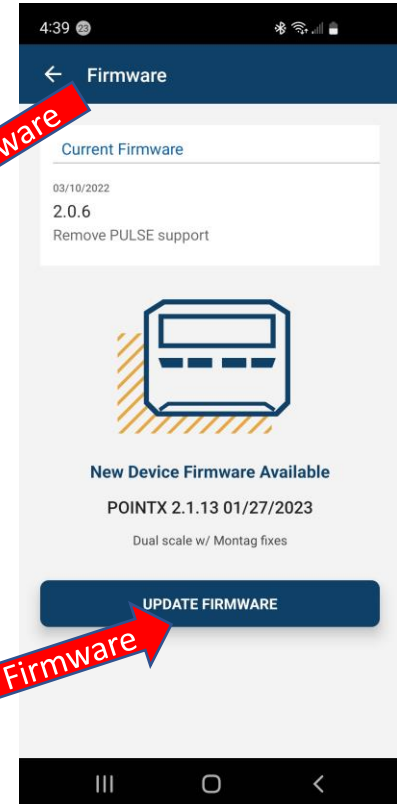
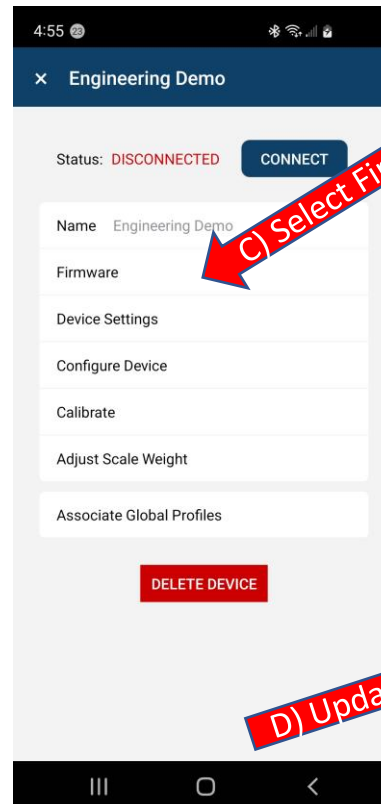
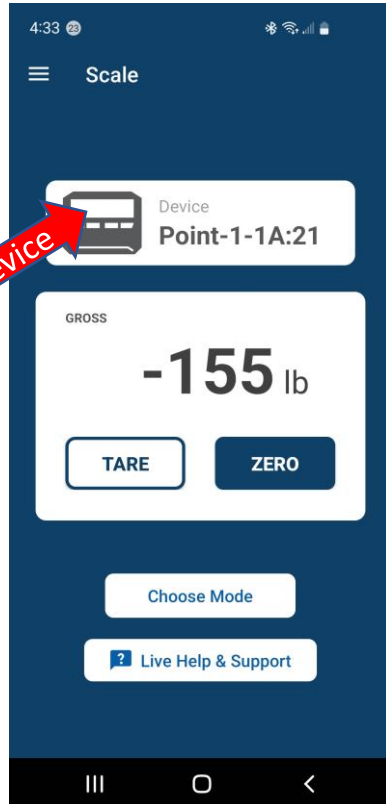
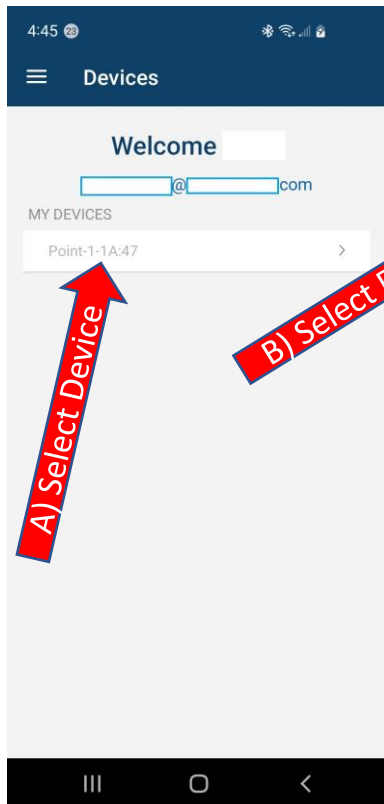



MONTAG 1 PRODUCT POINT INSTALL

UPDATE POINT TO LATEST VERSION - CONTINUED

5) Update may take 5 min

6) Close Point App and shut down Point display

7) Start Point Display and Launch Point App system

8) Auto-Calibration may be required on restart

9) Press OK, settings will be downloaded

10) Update complete, you can now use the Point system

Once the ISO is plugged in and the rate controller has power, push the power button on the “Point”. Now it should power up and down with the ISOBUS system.

“Point” ISO Virtual Terminal Display

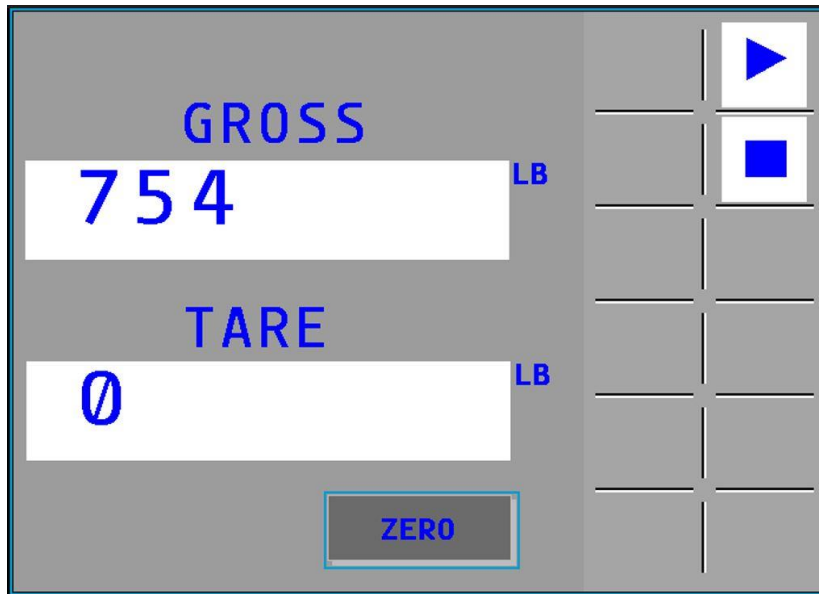

If using a Montag Dry Rate Controller, scale weights should also show up on the MDRC virtual terminal in the tank icons